

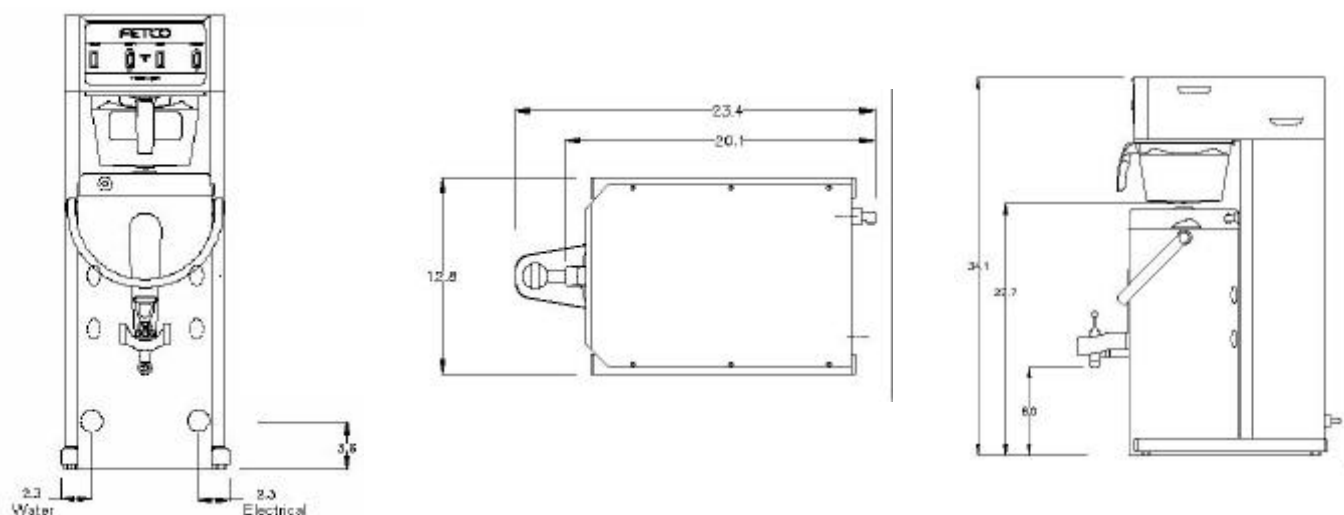

**MODEL TBS-21A**  
**SERIES Iced Tea / Coffee**



**Dimensions (Brewer):**

Height - 34" (850mm) Width - 12 3/4" (320mm) Depth - 20" (500mm)

**Dimensions (Shipping): Ships By Pallet**

Height - 34" (850mm) Width - 12 3/4" (320mm) Depth - 20" (500mm)

Weight - 76 lbs (34.5 kg)

**Water Requirements:**

20 -75 psig, 1.5 gpm flow rate, water inlet is 3/8 male flare

Electrical Config. Code	Heater Configuration	Voltage (AC)	Phase	Wires	KW	Maximum Amp draw	Batches Per Hour *
E21016	1 X 2.1KW	120	single	2 + ground	2.2	18.0	6.0

\* based on factory settings

**Options**

- Z004 Custom Color Finish
- Z005 Color Coded Faucet Handle

**Dispensers**

- D031 3.0 Gallon Iced-Tea Dispenser (ITD-30)
- D041 3.0 Liter Stainless Steel Lined Lever Airpot
- D042 Case of 3.0 Liter Stainless Steel Lined Lever Airpots (Case of 6)

**Accessories**

- A015 Round Drip Tray
- A039 In-Line Water Filter With Cartridge
- A070 3.0 Gallon Iced-Tea Dispenser Liner
- A075 Replacement Water Filter Cartridge
- A081 13" x 5" Iced-Tea Basket

**Filters**

- F001 15" x 5" paper Filters (500 Per Case) Standard
- F002 13" x 5" Paper Filters (500 Per Case)

**FETCO® Corporation**  
**640 Heathrow Drive**  
**Lincolnshire, Illinois 60069**  
**USA**

**Phone: (847) 821-1177**  
**Toll Free: (800) FETCO-99**  
**FAX: (847) 821-1178**  
**sales@fetco.com**  
**http://www.fetco.com**

Printed in USA 2002

FETCO, LUXUS, Extractor, Pulse-Brew are all trademarks or registered trademarks of Food Equipment Technologies Company.